

INSTALL GUIDE

Board & Batten- Install Guide

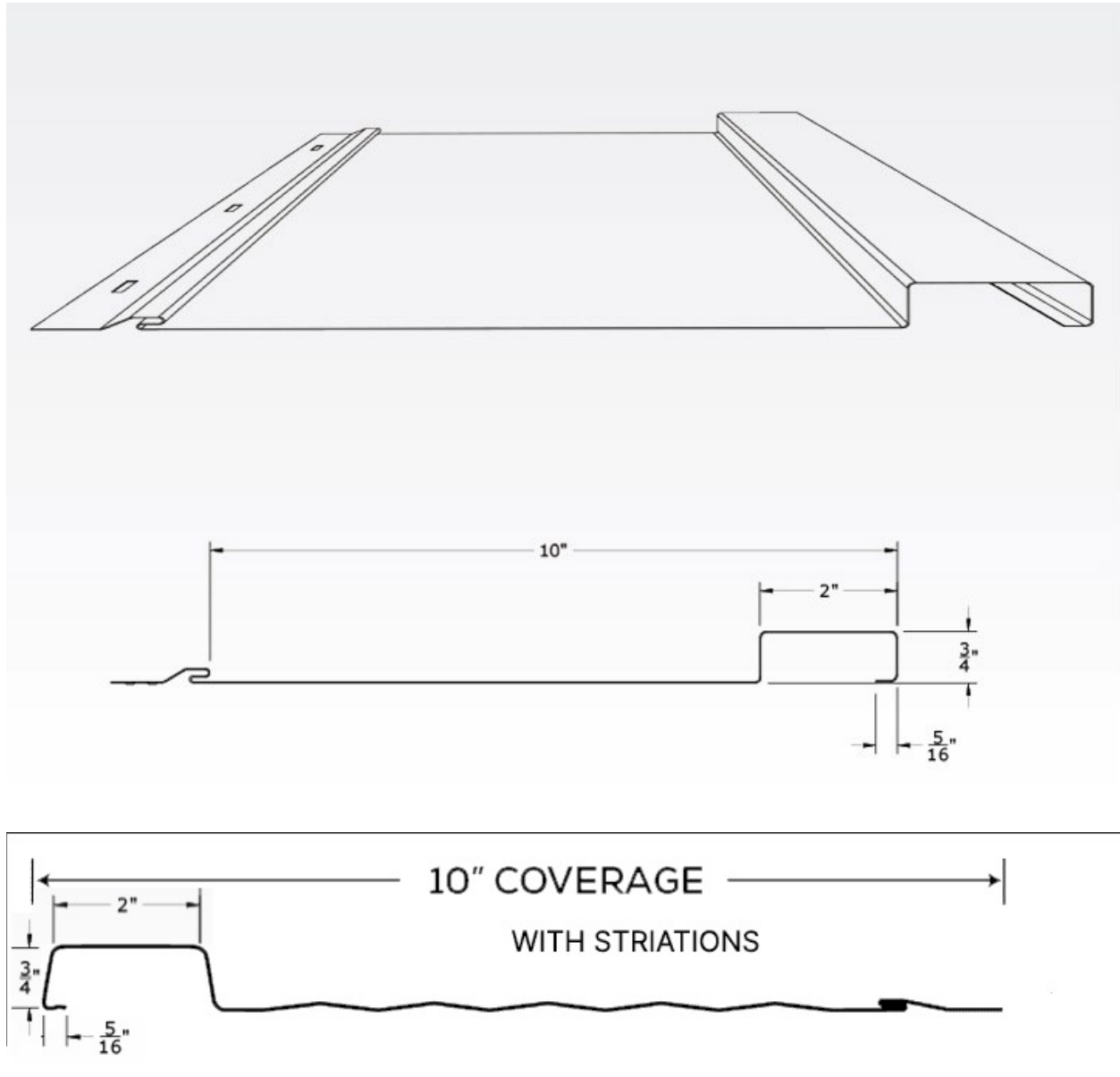

The Board & Batten product is a beautiful choice for siding in a residential environment. A solid substrate is required when installing this product.

Keeping plumb vertical laps is paramount when installing Board & Batten siding as well as establishing a “starting corner” for layout.

Visually layout your panels BEFORE starting the installation.



INSTALL GUIDE

Fastening for Board & Batten

Correct

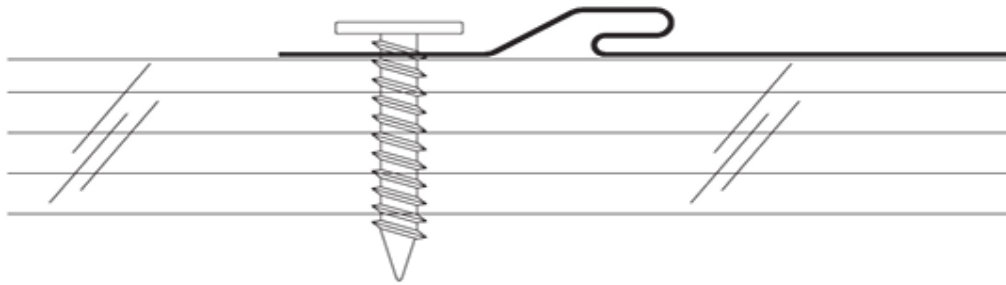

Incorrect

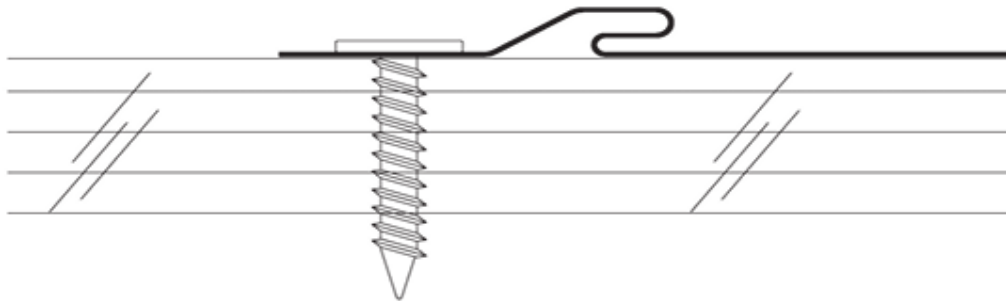

When fastening panels, it is important that you do NOT over “tighten” them. Over tightening will not allow the panel to expand and contract.

After the panel is installed, you should be able to move the panel up and down. However, there should not be a tendency for the panel to rattle or to be notably “loose”.



INSTALL GUIDE

F&J TRIM FOR PANELS AND SOFFIT

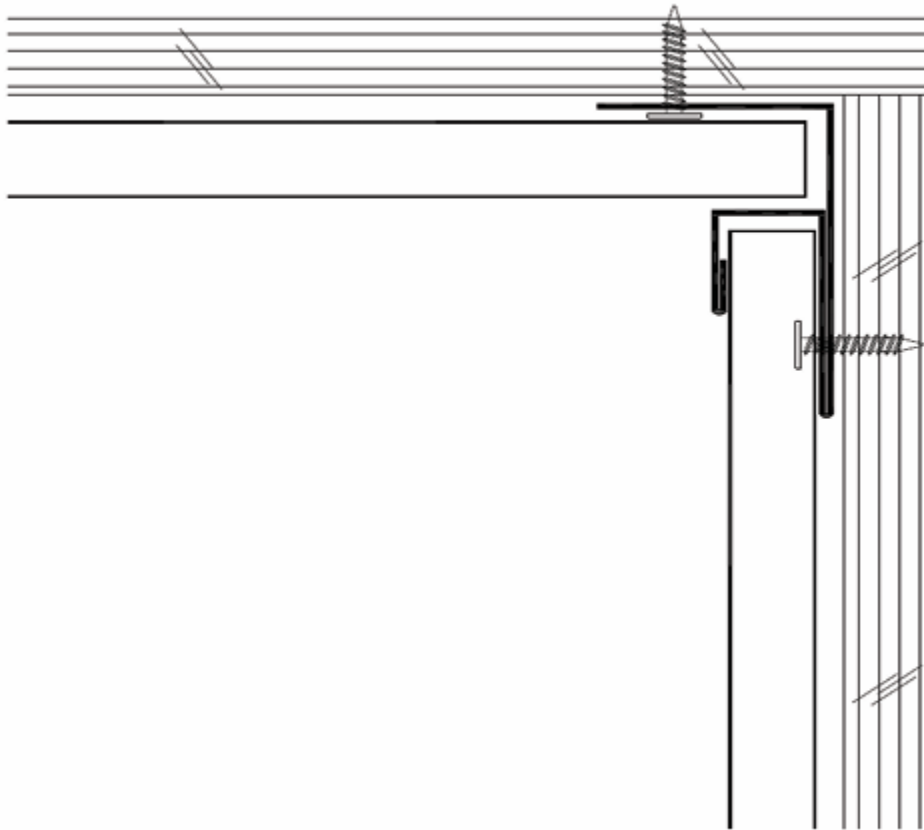

In terminating the Board & Batten into a soffit panel, the F&J trim will finish the edges and provide a closed edge for the soffit and sidewall panels.



INSTALL GUIDE

J- Trim

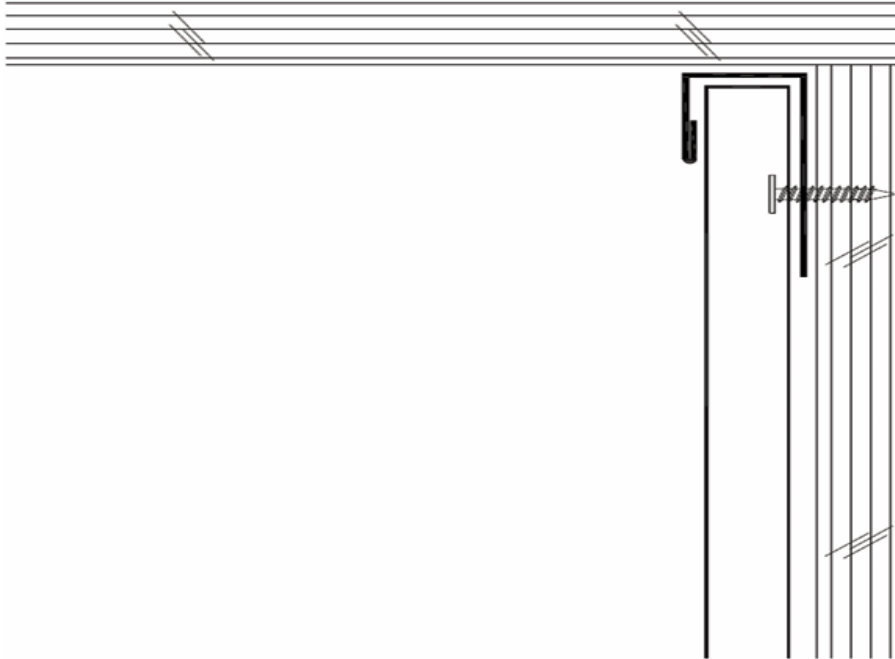

Use J trim to terminate into wooden soffit, doors, windows, and trimming around vents. When installing J – channel make sure that you leave enough room to allow for expansion and contraction.

INSTALL GUIDE

Drip Cap

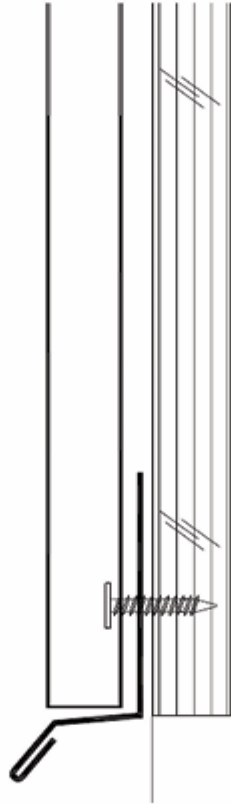

Drip Cap helps direct water away from door and windows openings. It can be used as a transition trim over rock, brick, and stone. Fasten with pan head screws or trim nails.



INSTALL GUIDE

Rat Guard, Square Base

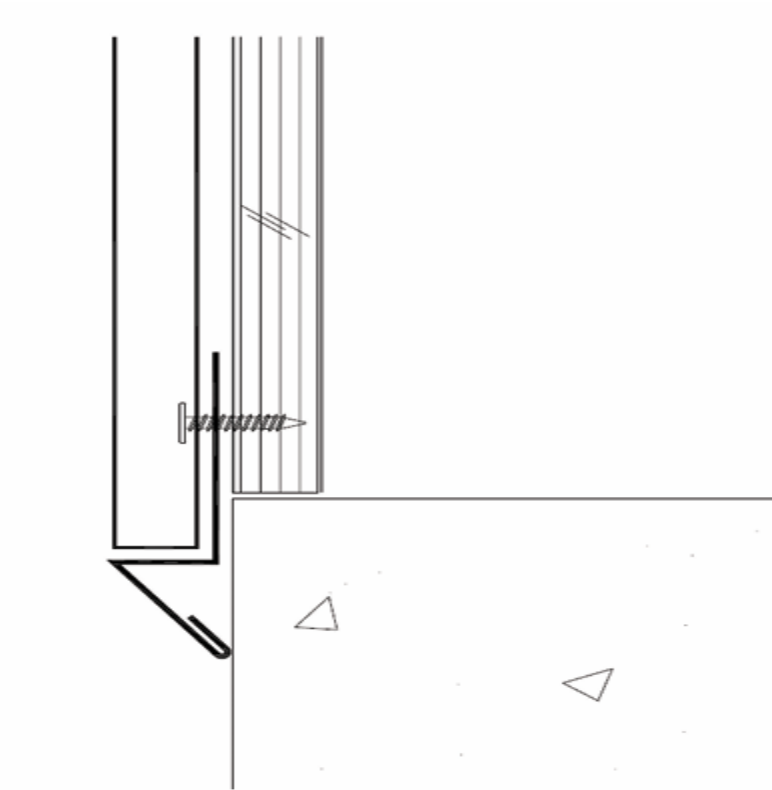

Rat guard or Square base should be used as a trim to seal between the sidewall panel, the concrete, and substrate. Its main purpose is to help with moisture and rodent control.



INSTALL GUIDE

6" Outside Corner

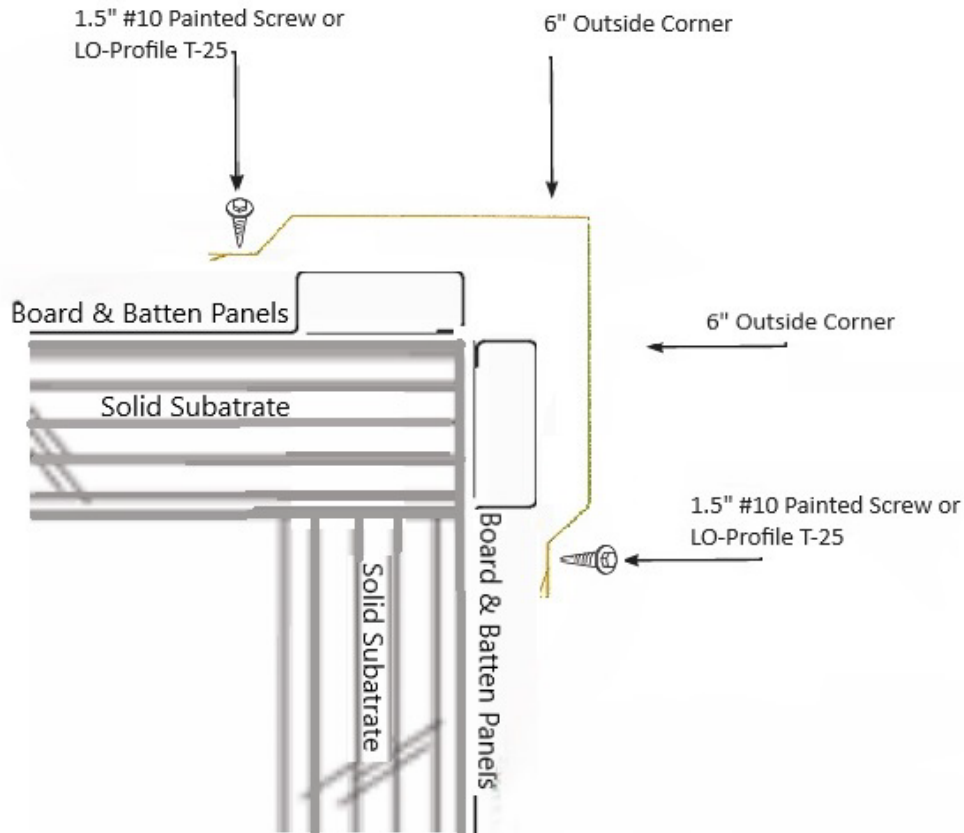

It is always a good idea to “dry fit” a corner before fastening it into place . Checking to insure the corner is square with the corner of the structure.

The peak bend of the corner should be in alignment with the corner of the structure all the way up and down the wall junction. Next plum the corner vertically. Insure the top and bottom of the corner is not in or out too far.

A 6” Outside Corner can be used to conceal and finish the corner. Fastening through the kicker, panel, and into the substrate. This will secure the corner to the structure.



INSTALL GUIDE

A note on oil canning

Board and Batten panels can be prone to oil canning. Here are a few suggestions to consider when contemplating Board and Batten panels:

1. Avoid long runs (over 12') on 29 Gauge non-striated panels.
2. On longer runs break up your panel lengths with belly bands (double angles)
3. Do not over-tighten the fasteners allowing for some movement in the panel.
4. For long continuous runs 26 Gauge striated panels will be your best option to resist oil canning

